

Mounting brackets Festebraketter

TYPE FBS 205825

Dim./Mål: 130x23x12mm
2 mounting brackets per unit. Designed for type:

2 festebraketter pr. enhet. Beregnet for type:
719, 8421, 9522, 9150, 9521, 9221, 9527, 2026, 9623, 2024, 9726, 2023, 2047



TYPE FAS 207724

Dim./Mål: 80x20x8mm
2 mounting brackets per unit. Designed for type:

2 festebraketter pr. enhet. Beregnet for type:
9120, 9320, 9322

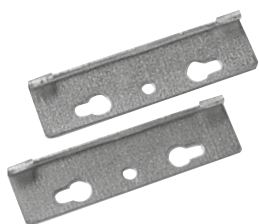

TYPE LME 207818

Dim./Mål: 93x75mm
1 mounting bracket per unit. Designed for type:

1 festebrakett pr. enhet. Beregnet for type:
6820, 8930, 8931, 6823, 8937, 7504

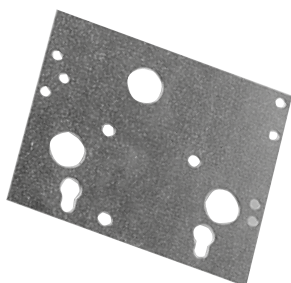

TYPE FCS 202718

Dim./Mål: 110x30x12mm
2 mounting brackets per unit. Designed for type:

2 festebraketter pr. enhet. Beregnet for type:
8921, 9260, 2043, 2044, 9660, 2025



TYPE 202906

Dim./Mål: 46x47x36mm
1 mounting bracket per unit. Designed for type: *

1 festebrakett per enhet. Beregnet for type: *
2240, 2121, 2122, 2124, 2125, 2115



TYPE 201565

Dim./Mål: 60x69x38mm
1 mounting bracket per unit. Designed for type: *

1 festebrakett per enhet. Beregnet for type: *
9920, 9921, 9922, 9940, 2246, 2215, 2515, 2541, 2544



TYPE 201970

Dim./Mål: 72x82x45mm
1 mounting bracket per unit. Designed for type:

1 festebrakett per enhet. Beregnet for type:
2020, 2022, 2040, 2415, 2440, 2641



TYPE 9000-16 KLIPS ENGAGEMENT FOOT

FM4 engagement foot for TS-35 (35 mm DIN rail). Used in combination with mounting brackets. Supplied in two-pack.

FM4 klips for TS-35 (35 mm DIN skinne). Brukes i kombinasjon med festebraketter. Pakket i poser à 2 stk.



Miscellaneous Diverse



TYPE 131306

2-pin IEC 60320/C7 cord set, 1,8 meter



TYPE 013095

3-pin IEC 60320/C13 cord set, 1,8 meter



TYPE 9998

Remote control with 5 m cable for inverter models 9987, 9988 and 2287

Fjernkontroll med 5 m kabel for inverter modellene 9987, 9988 og 2287